

# BluePiano User Manual (App to use with Android Device)

Go to google play and download the App Blue Piano

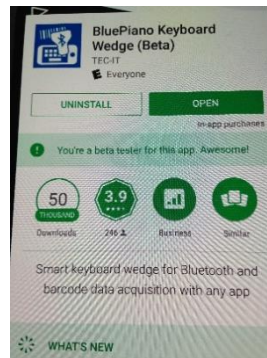

Download Excel to Android Device

Open Blue Piano and tap Keyboard preferences

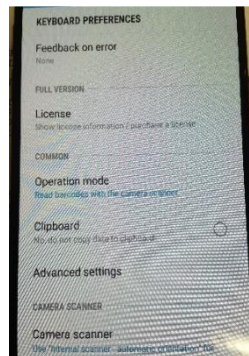

Scroll to Keyboard Behavior and tap

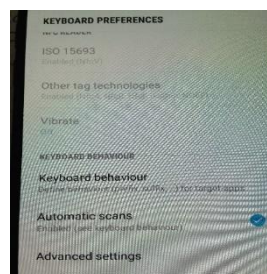

Mark the circle to enable Excel and uncheck the others

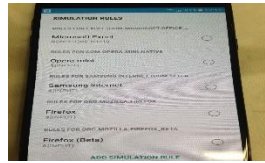

Tap the words Microsoft Excel

Scroll to Prefix and Suffix setting and touch

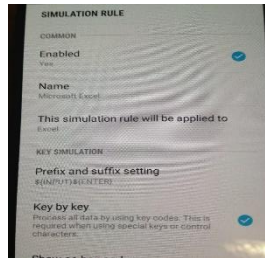

Delete the line that is in the placeholder.

Touch placeholder, touch the option Scanned barcode/NFC UID

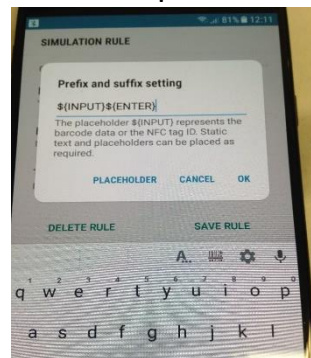

Touch placeholder again and select Enter

Select ok

On the bottom touch save rule

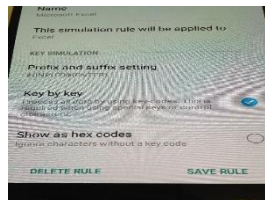

Go back to Keyboard Preferences page

Touch Device type and select Bluetooth client

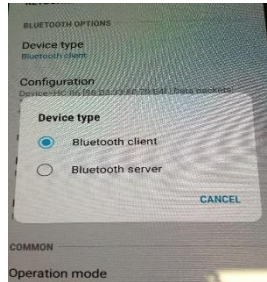

Touch Configuration

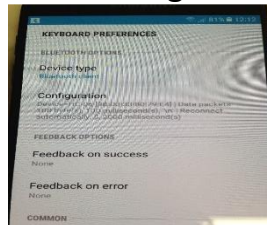

Touch paired device



Touch Bluetooth Settings (make sure the reader is turned on and Bluetooth on the device is on)

Find reader, usually called HC-06 and pair to it.

Now open Excel

Highlight Column A

Set column Numbers Format

Select General

Set Decimal Point

Highlight first spot you want RFID Number to go into

Start reading RFID Tags